

B-B (1 : 1)

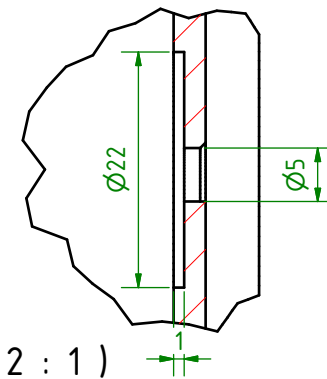
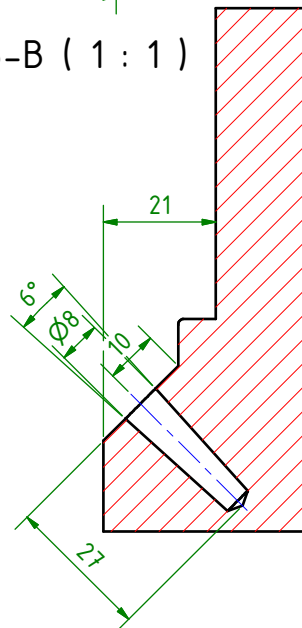

C (2 : 1)

√ Rz16

Maßstab 1:5

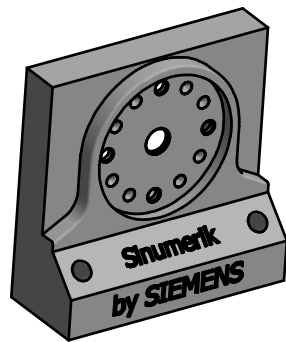

Allgemeintoleranz ISO 2768-mk		Oberfläche DIN-ISO 1302		Maßstab: 1:1		Kantenbruch: 0,5x45°	
Datum 15.09.2016		Name Jens Biber		Werkstoff: AlCuMgPb 100x100x45			
Gezeichnet 27.09.2016		Kontr. Name H-P Moser		Uhr			
Norm				Handwerkskammer Ulm			
Status		Änderungen		Datum		Name	
Workshop Karlsruhe						1 A3	